

2000 I-30 E
Greenville, TX 75402

Tuesday, August 15, 2023

Office of Hopkins County Judge
PO Box 288
Sulphur Springs TX 75483

Farmers Electric Cooperative Member: Lisa Chester
Service Order Number: 2023082001

Greetings:

Farmers Electric Cooperative, Inc. is requesting permission to construct electrical power distribution facilities which will cross County Road 3338 which is located 1,317 East of County Road 3341 S in Hopkins County, Texas.

Site location map and construction sketches are attached. The construction sketch details the proposed work. All road crossings will have a minimum vertical clearance of 22 feet.

If you have any questions, please contact me at any time.

Sincerely,

Choose an item.
Project Coordinator
jsanchez@farmerselectric.coop
Phone Choose an item.

Submitted by Shaya Smith
ssmith@farmerselectric.coop
Engineering Coordinator

Enclosures

County Approval Section:

Approved: ✓

Denied: _____

Authorized Signature: Wade Bentley Date: 3/28/23



2000 I-30 E
Greenville, TX 75402

S/O#2023082001 LISA CHESTER

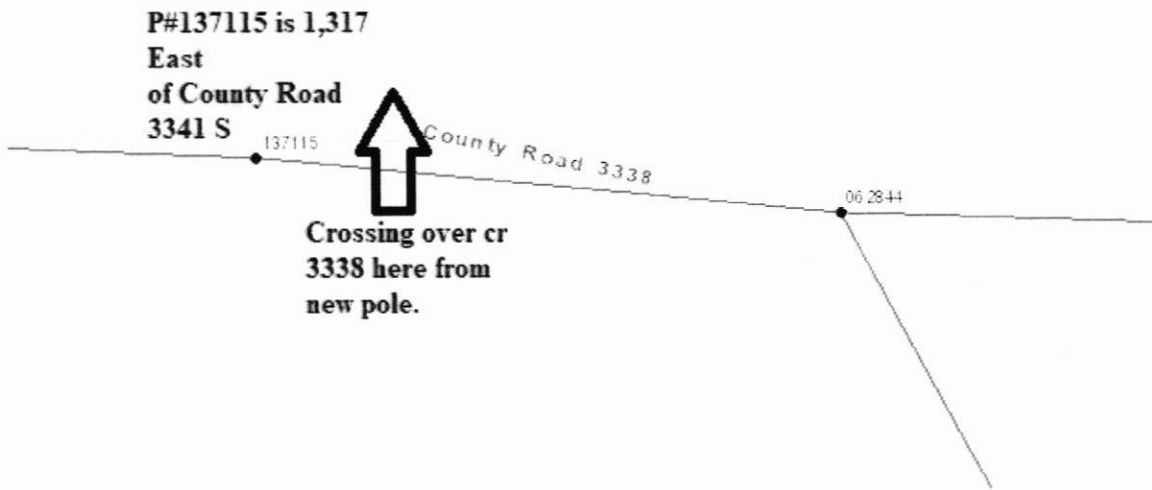



2000 I-30 E
Greenville, TX 75402

Friday, August 25, 2023

Office of Hopkins County Judge
PO Box 288
Sulphur Springs TX 75483

Farmers Electric Cooperative Member: Alvin Rauschhuber
Service Order Number: 2023072737

Greetings:

Farmers Electric Cooperative, Inc. is requesting permission to construct electrical power distribution facilities which will cross County Road 4732 which is located 550' E of FM 275 in Hopkins County, Texas.

Site location map and construction sketches are attached. The construction sketch details the proposed work. All road crossings will have a minimum vertical clearance of 22 feet.

If you have any questions, please contact me at any time.

Sincerely,

Meagan Lee

Project Coordinator
meaganl@farmerselectric.coop
Phone 903-513-0378

Submitted by Psalm Harper
pharper@farmerselectric.coop
Engineering Coordinator

Enclosures

County Approval Section:

Approved: _____ Denied: _____

Authorized Signature: *Psalm Harper*

Date: 8-28-23

crossing cr 4732 at pole 059469 which is 550' E of FM 275

County Road 4732

